

# Appendix I

## Bridge Lengthening and Weirs at Lake Shore Boulevard

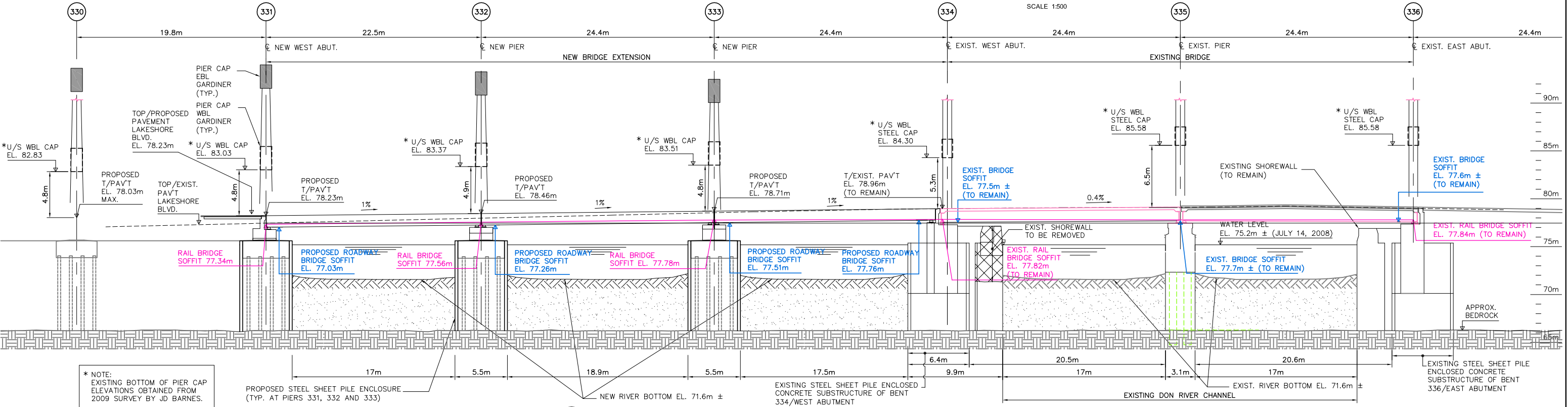

G:\PROJECTS\42-42-97\42-97\42-97\Drawings\SKETCHES\Structural\Lakeshore Bridge Extension\_Cant-Bl.dwg 10/14/2009 3:05:53 PM EDT

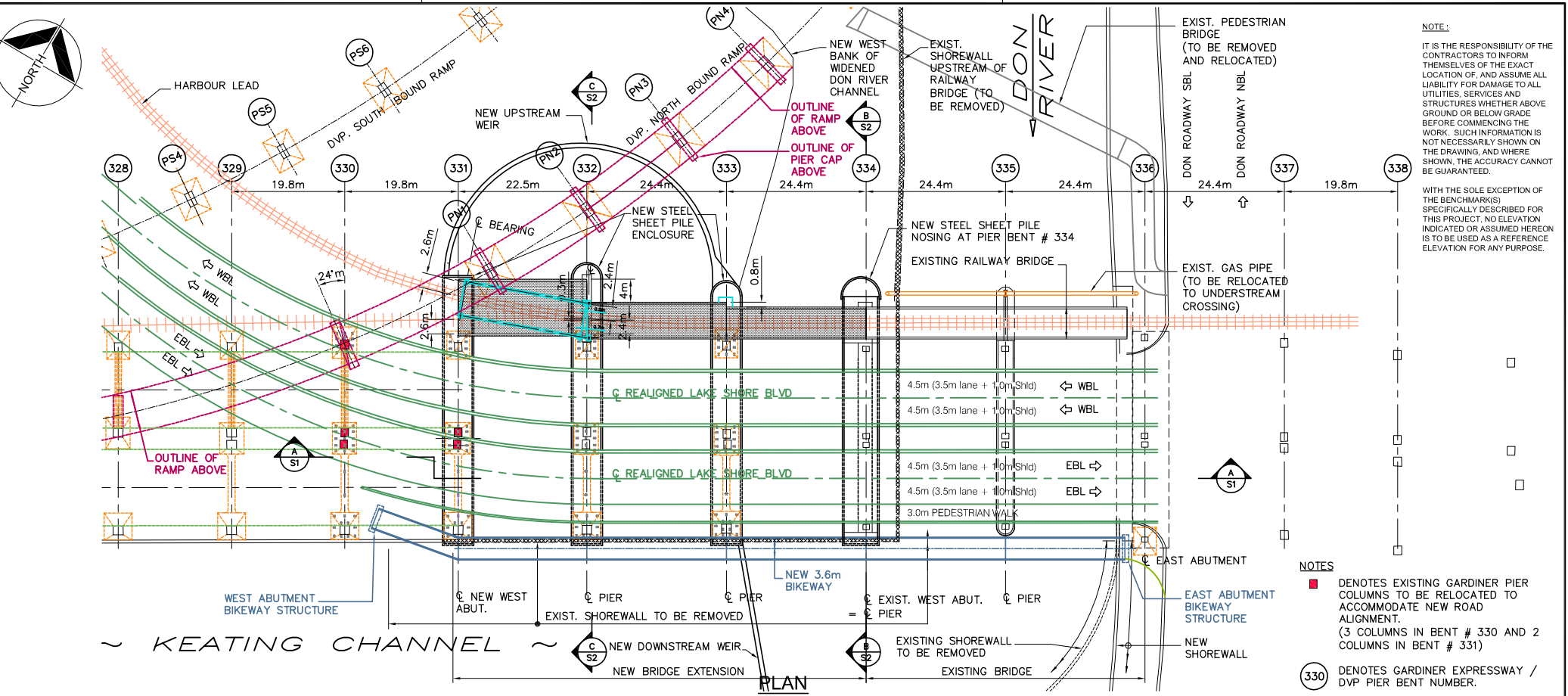
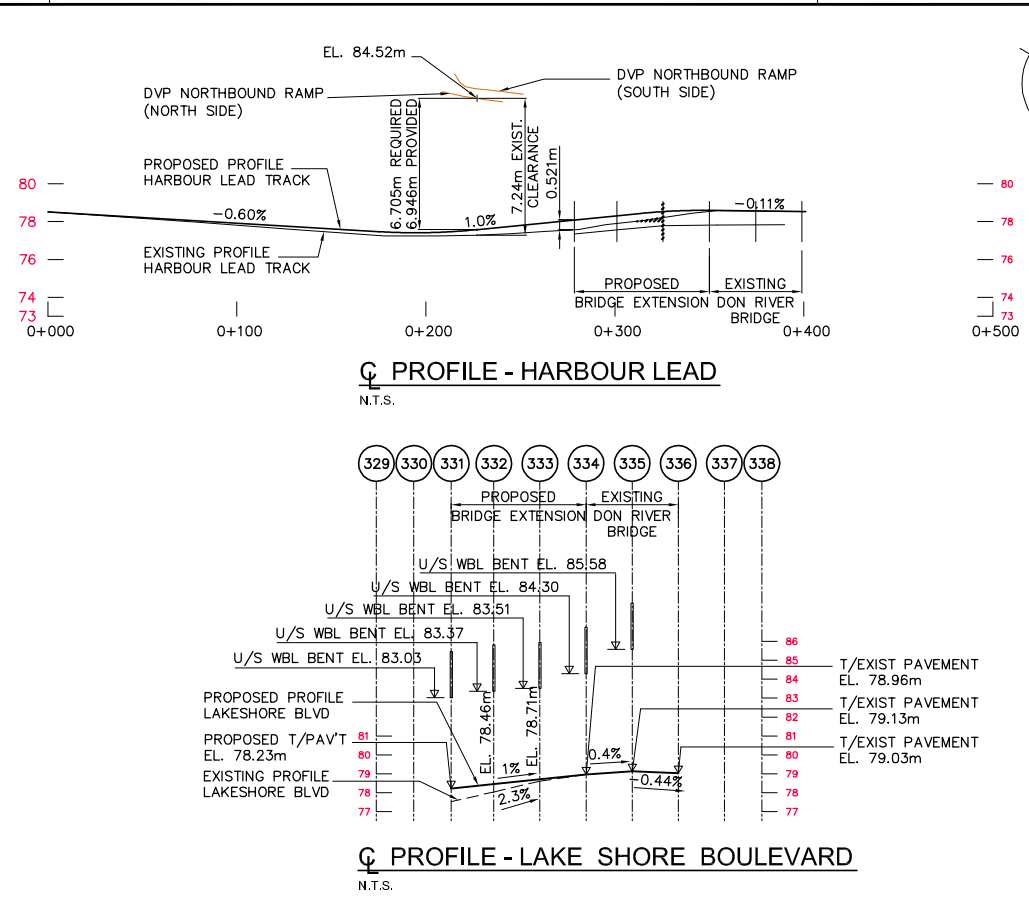

- NOTES**
- DENOTES EXISTING GARDINER PIER COLUMNS TO BE RELOCATED TO ACCOMMODATE NEW ROAD ALIGNMENT. (3 COLUMNS IN BENT # 330 AND 2 COLUMNS IN BENT # 331)
  - 330 DENOTES GARDINER EXPRESSWAY / DVP PIER BENT NUMBER.

**NOTE:**  
IT IS THE RESPONSIBILITY OF THE CONTRACTORS TO INFORM THEMSELVES OF THE EXACT LOCATION OF, AND ASSUME ALL LIABILITY FOR DAMAGE TO ALL UTILITIES, SERVICES AND STRUCTURES WHETHER ABOVE GROUND OR BELOW GRADE BEFORE COMMENCING THE WORK. SUCH INFORMATION IS NOT NECESSARILY SHOWN ON THE DRAWING, AND WHERE SHOWN, THE ACCURACY CANNOT BE GUARANTEED.

WITH THE SOLE EXCEPTION OF THE BENCHMARK(S) SPECIFICALLY DESCRIBED FOR THIS PROJECT, NO ELEVATION INDICATED OR ASSUMED HEREON IS TO BE USED AS A REFERENCE ELEVATION FOR ANY PURPOSE.

<p><b>AECOM</b></p> <p>AECOM Canada Ltd. 300 Water Street, Whitby, Ontario, Canada L1N 9J2 T905.668.9363 F905.668.0221</p>	<p>CLIENT:</p> <table border="1" style="width: 100%; border-collapse: collapse;"> <tr> <td style="width: 5%;">3</td> <td style="width: 15%;">JUL. 2009</td> <td style="width: 10%;">MGS</td> <td style="width: 70%;">CANTILEVERED BIKEWAY STRUCTURE</td> </tr> <tr> <td>2</td> <td>APR. 2009</td> <td>MGS</td> <td>ROAD GRADE LOWERED</td> </tr> <tr> <td>1</td> <td>FEB. 2009</td> <td>MGS</td> <td>RAIL GRADE RAISED</td> </tr> <tr> <td>No.</td> <td>DATE</td> <td>BY</td> <td>ISSUES / REVISIONS</td> </tr> </table>	3	JUL. 2009	MGS	CANTILEVERED BIKEWAY STRUCTURE	2	APR. 2009	MGS	ROAD GRADE LOWERED	1	FEB. 2009	MGS	RAIL GRADE RAISED	No.	DATE	BY	ISSUES / REVISIONS	<p>DRAWN BY: B.J. BUCKING</p> <p>CHECKED BY: M.G. SHALLHORN</p> <p>DESIGNED BY: MGS / KA</p> <p>APPROVED BY:</p> <p>SCALE: AS SHOWN</p> <p>DATE: JULY, 2009</p>	<p>PROJECT: LOWER DON LANDS</p> <p>DRAWING: LAKE SHORE BOULEVARD BRIDGE EXTENSION GENERAL ARRANGEMENT - 1 PLAN AND SECTION</p>	<p>PROJECT No.: 109446</p> <p>DRAWING No.: S1</p>
3	JUL. 2009	MGS	CANTILEVERED BIKEWAY STRUCTURE																	
2	APR. 2009	MGS	ROAD GRADE LOWERED																	
1	FEB. 2009	MGS	RAIL GRADE RAISED																	
No.	DATE	BY	ISSUES / REVISIONS																	



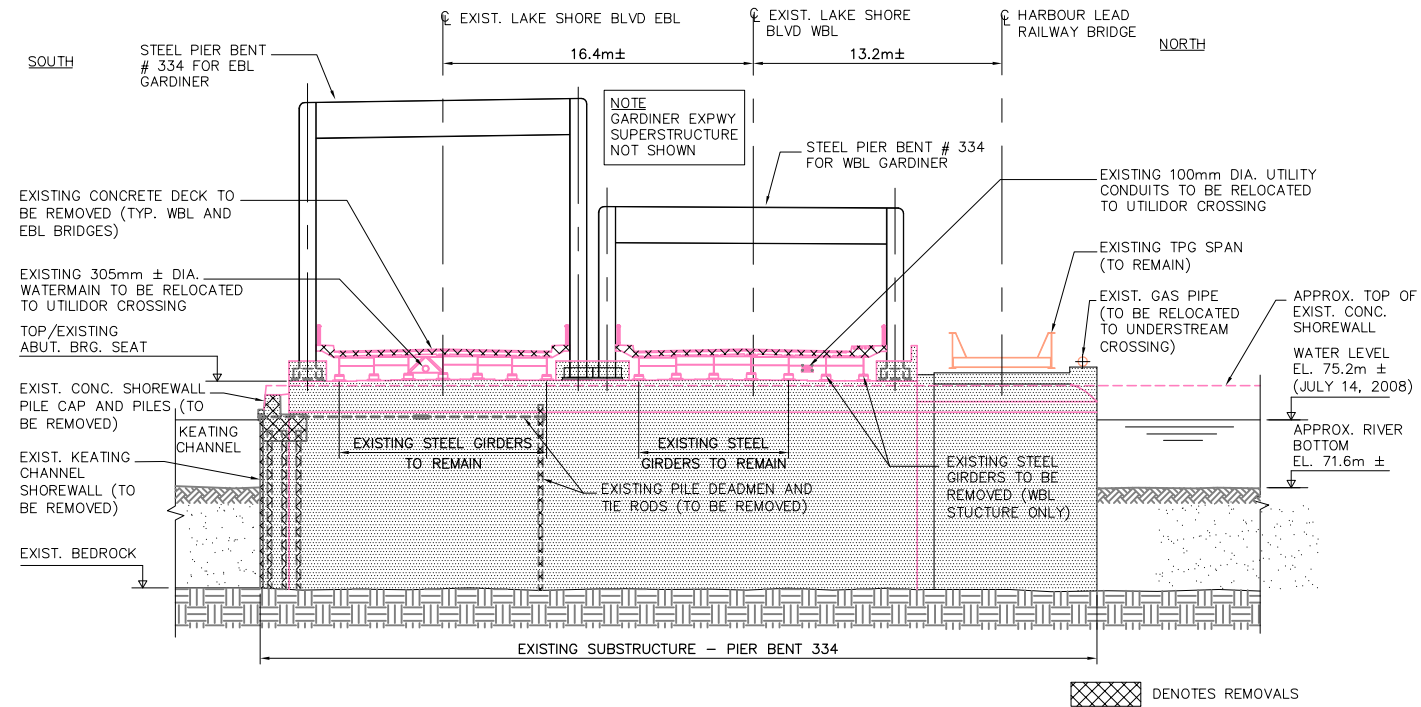

**SECTION B S1 EXISTING CONDITION**  
 SCALE 1:200  
 (DECK SECTION AT EXISTING WEST ABUTMENT, BENT # 334)

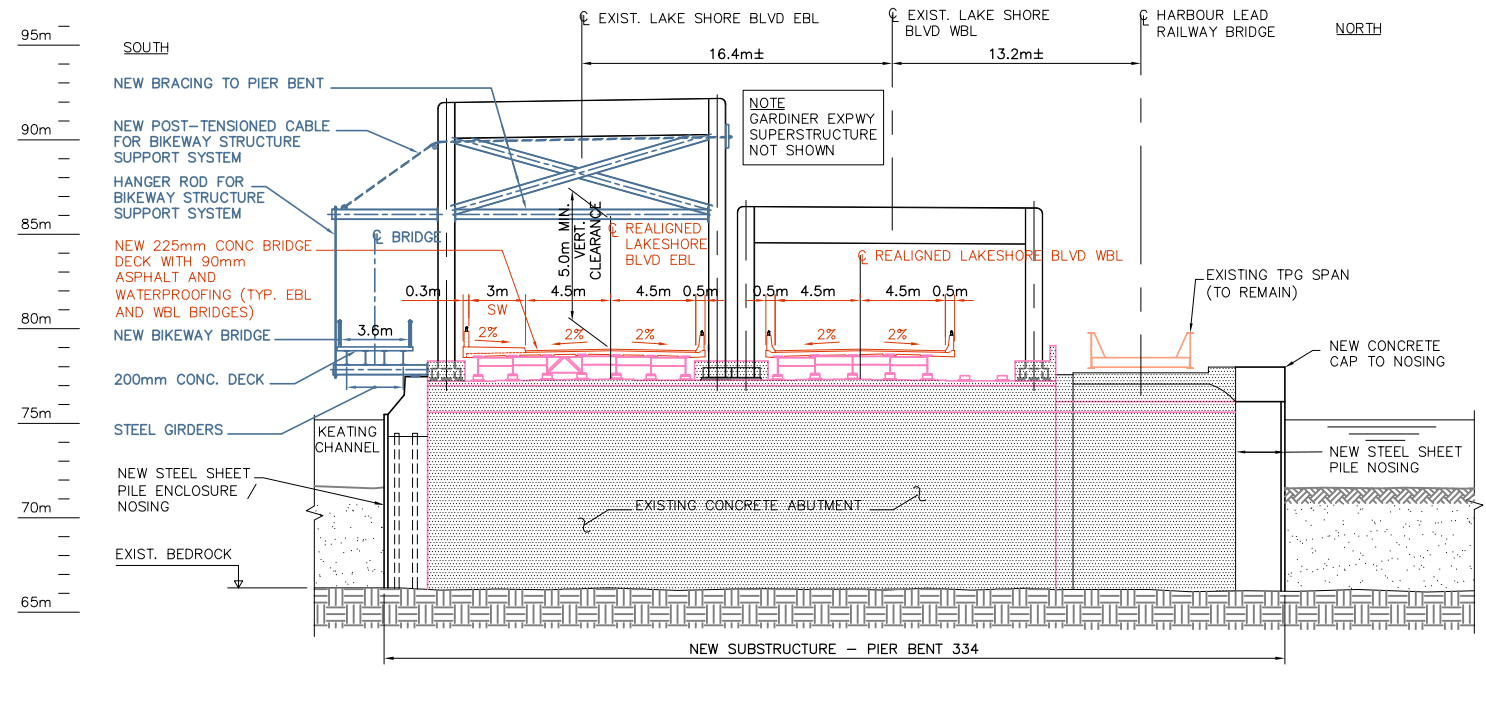

**SECTION B S1 NEW CONSTRUCTION**  
 SCALE 1:200  
 (DECK SECTION AT EXISTING WEST ABUTMENT, BENT # 334)

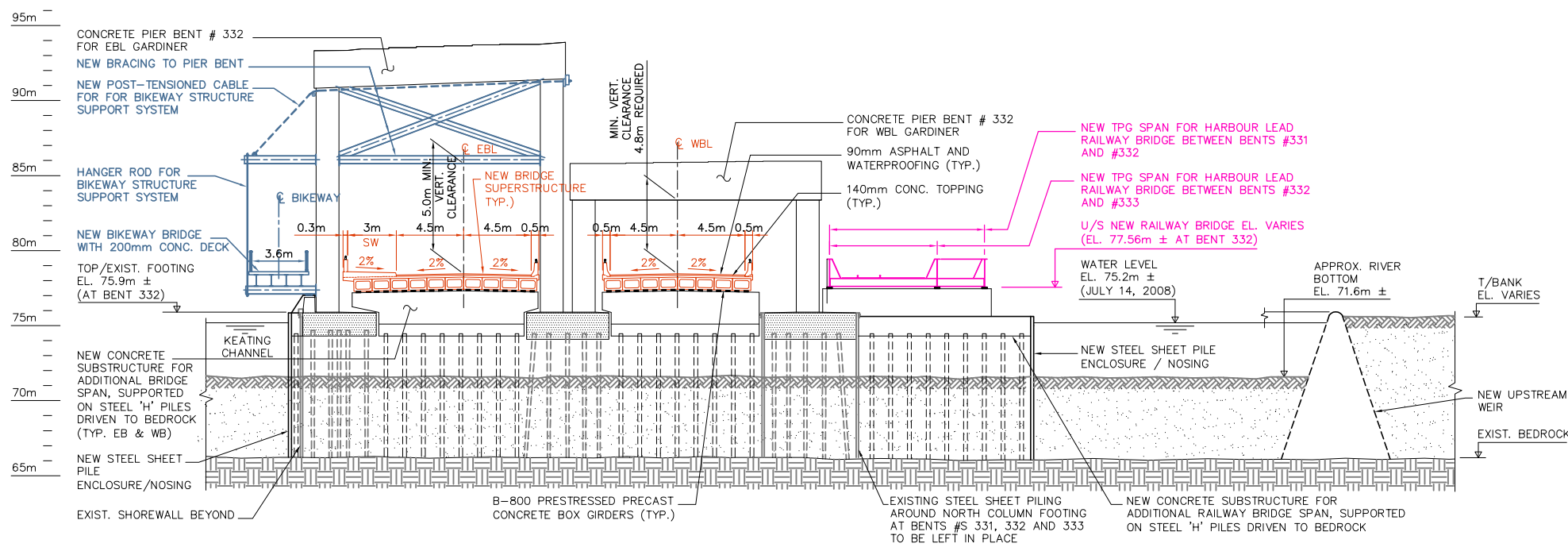

**SECTION C S1 NEW CONSTRUCTION / BRIDGE EXTENSION**  
 SCALE 1:200  
 (SECTION SHOWN AT BENT # 332. SECTION AT BENT # 333 SIMILAR)

**NOTE:**  
 IT IS THE RESPONSIBILITY OF THE CONTRACTORS TO INFORM THEMSELVES OF THE EXACT LOCATION OF, AND ASSUME ALL LIABILITY FOR DAMAGE TO ALL UTILITIES, SERVICES AND STRUCTURES WHETHER ABOVE GROUND OR BELOW GRADE BEFORE COMMENCING THE WORK. SUCH INFORMATION IS NOT NECESSARILY SHOWN ON THE DRAWING, AND WHERE SHOWN, THE ACCURACY CANNOT BE GUARANTEED.  
 WITH THE SOLE EXCEPTION OF THE BENCHMARK(S) SPECIFICALLY DESCRIBED FOR THIS PROJECT, NO ELEVATION INDICATED OR ASSUMED HEREON IS TO BE USED AS A REFERENCE ELEVATION FOR ANY PURPOSE.

**NOTE:**  
 ALL DIMENSIONS ARE APPROXIMATE

C:\PROJECTS\42-42-97-42-97007 - Lower Don Lands\8 DRAWINGS\SKETCHES\Structure\LakeShore Bridge Extension\_Cant-Bl.dwg 10/14/2009 3:05:53 PM EDT

ALL DIMENSIONS AND INFORMATION SHALL BE CHECKED AND VERIFIED ON THE JOB AND ANY DISCREPANCIES MUST BE REPORTED TO THE CONSULTANT BEFORE COMMENCING THE WORK. DRAWINGS ARE NOT TO BE SCALED.  
 THIS DRAWING AND ALL ASPECTS OF ITS CONTENT ARE PROTECTED BY COPYRIGHT. REPRODUCTION IN WHOLE OR IN PART, BY ANY MEANS WHATSOEVER, WHETHER ELECTRONIC, MECHANICAL OR OTHERWISE, WITHOUT THE EXPRESS WRITTEN PERMISSION OF TOTTEN SMS HUBBICK ASSOCIATES, IS PROHIBITED BY LAW.



AECOM Canada Ltd.  
 300 Water Street, Whitby, Ontario, Canada L1N 9J2  
 T905.668.9363 F905.668.0221

No.	DATE	BY	ISSUES / REVISIONS
3	JUL. 2009	MGS	CANTILEVERED BIWAY STRUCTURE
2	APR. 2009	MGS	ROAD GRADE LOWERED
1	FEB. 2009	MGS	RAIL GRADE RAISED

CLIENT:	
DRAWN BY:	B.J. BUCKING
CHECKED BY:	M.G. SHALLHORN
DESIGNED BY:	MGS / KA
APPROVED BY:	
SCALE:	AS SHOWN
DATE:	JULY, 2009

PROJECT:	LOWER DON LANDS
DRAWING:	LAKE SHORE BOULEVARD BRIDGE EXTENSION GENERAL ARRANGEMENT - 2 PROPOSED SECTIONS WITH CANTILEVERED BIWAY

PROJECT No.:	109446
DRAWING No.:	S2

